

3-73-**04**-0.1
3-73-**04**-1.1
5-73-**04**-0.1
5-73-**04**-1.1

joulia®
SWITZERLAND

DE Duschrinne mit Wärmetauscher - für **exklusive** Bodenbeläge.
FR Rigole de douche avec échangeur thermique - pour les revêtements de sol **exclusifs**.
EN Shower drain channel with heat exchanger - for **exclusive** floor coverings.
NL Douchegoot met warmtewisselaar - voor **exclusieve** vloerbedekkingen.

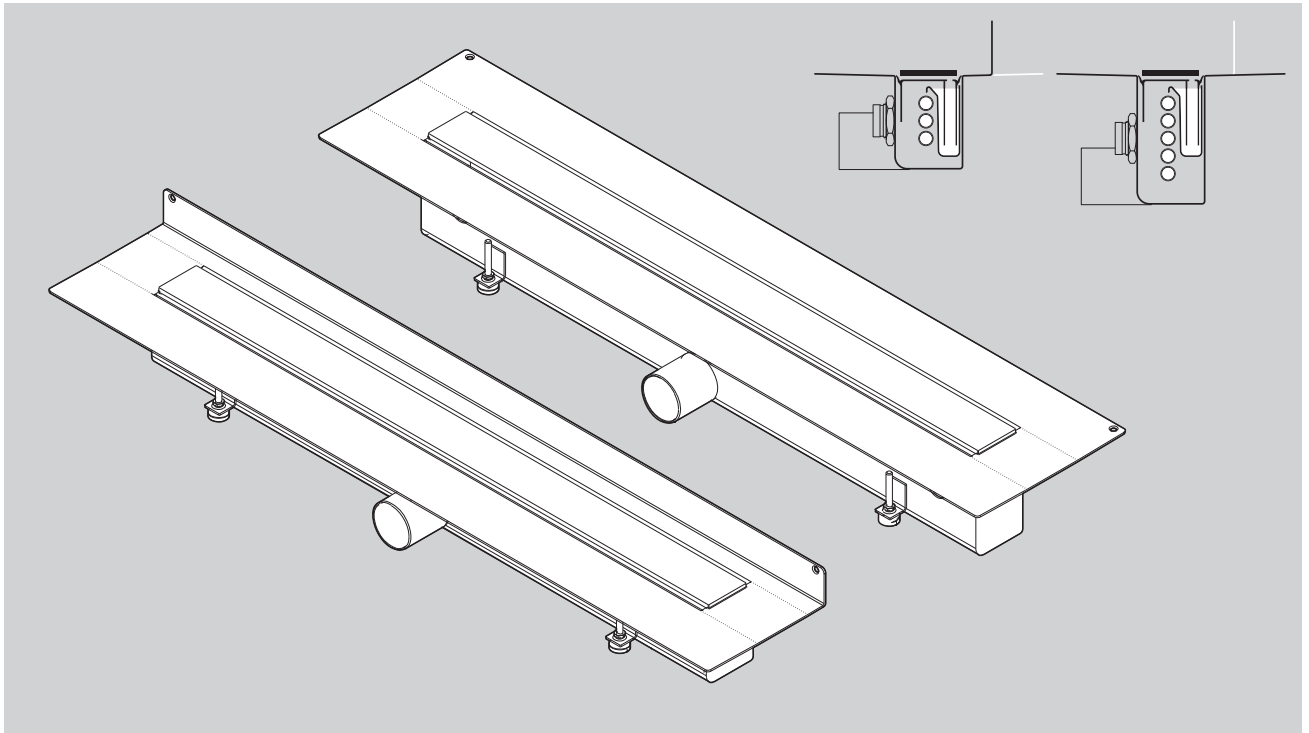

Zusätzliche Instruktionen.
Instructions complémentaires.
Further instructions.
Verdere instructies.

kiwa 

 SVGW

 WRAS
APPROVED PRODUCT

 DVGW

joulia® inline
SWITZERLAND



2-0-0-1.0
2-0-0-2.0
2-0-0-3.0
2-0-0-4.0

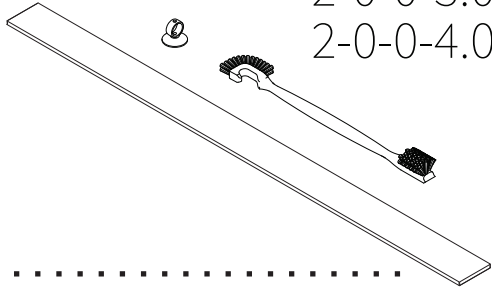

2-0-0-1.0
2-0-0-2.0
2-0-0-3.0
2-0-0-4.0

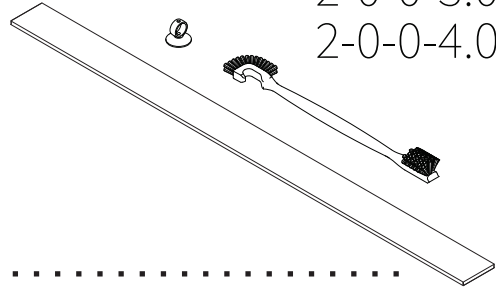

2-0-0-5.0

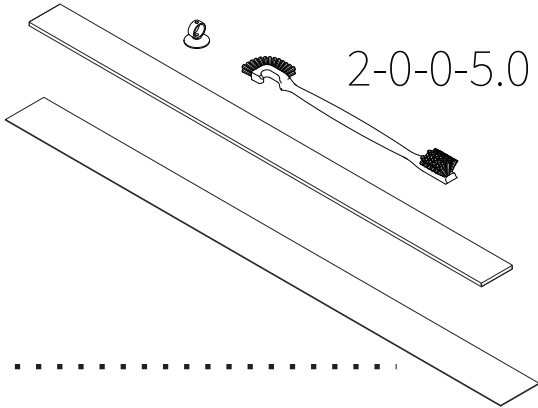

2-0-0-5.0

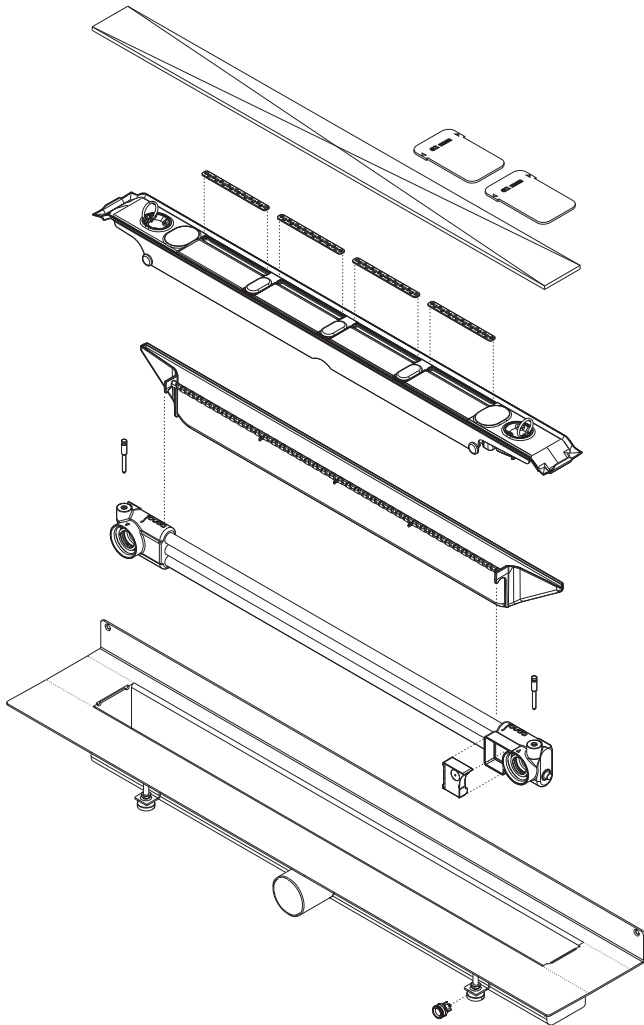
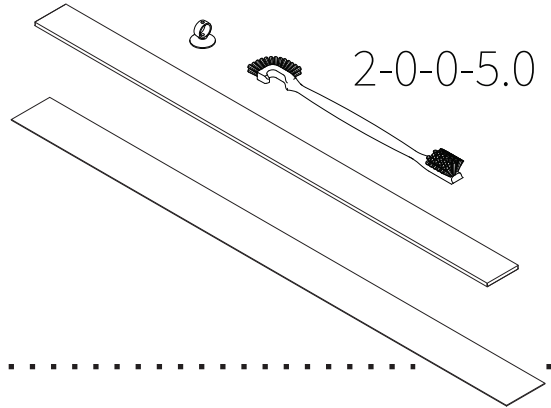

3-73-04-1.1

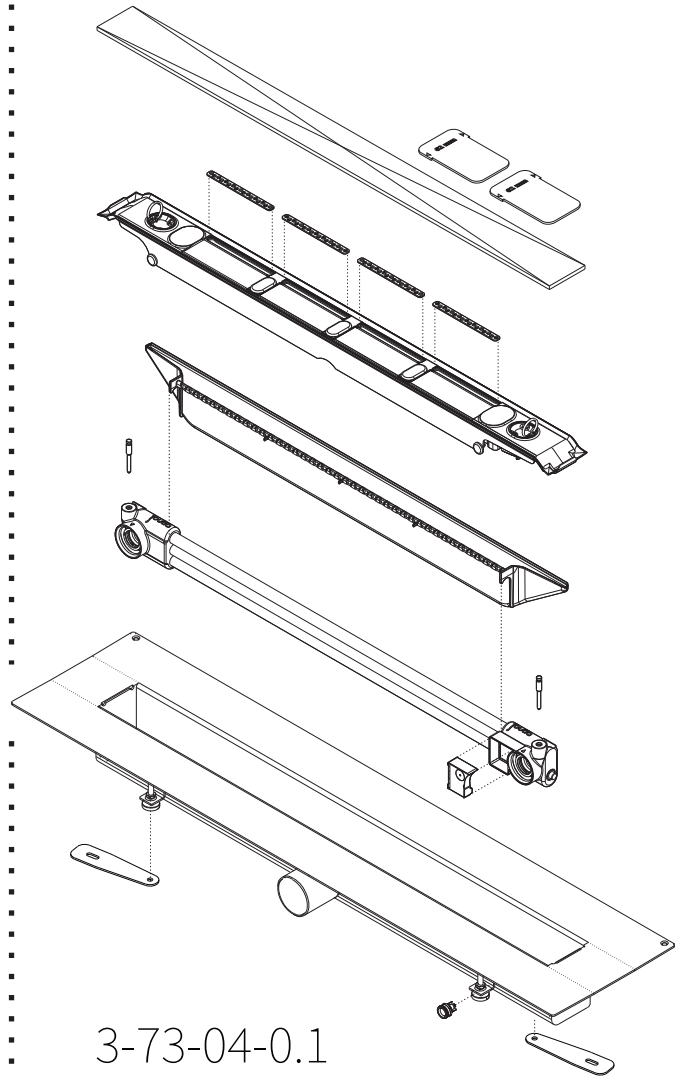

3-73-04-0.1



2-0-0-1.0
2-0-0-2.0
2-0-0-3.0
2-0-0-4.0

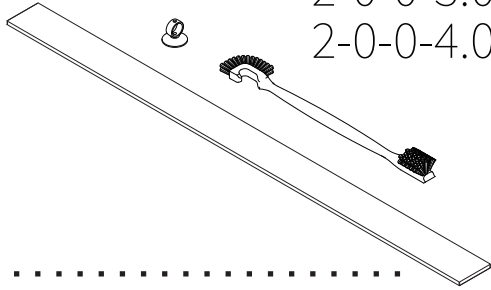

2-0-0-1.0
2-0-0-2.0
2-0-0-3.0
2-0-0-4.0

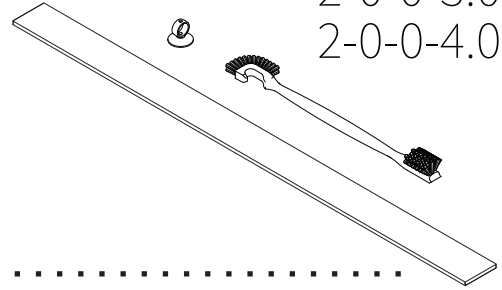

2-0-0-5.0

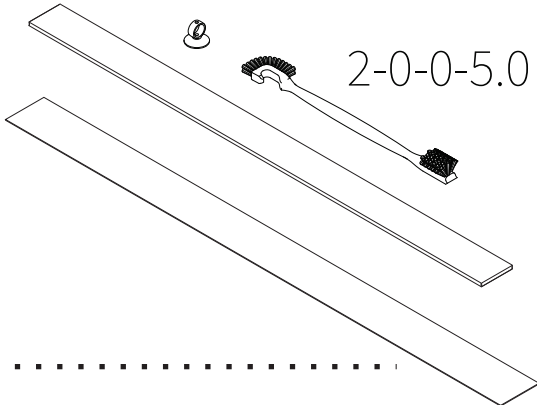

2-0-0-5.0

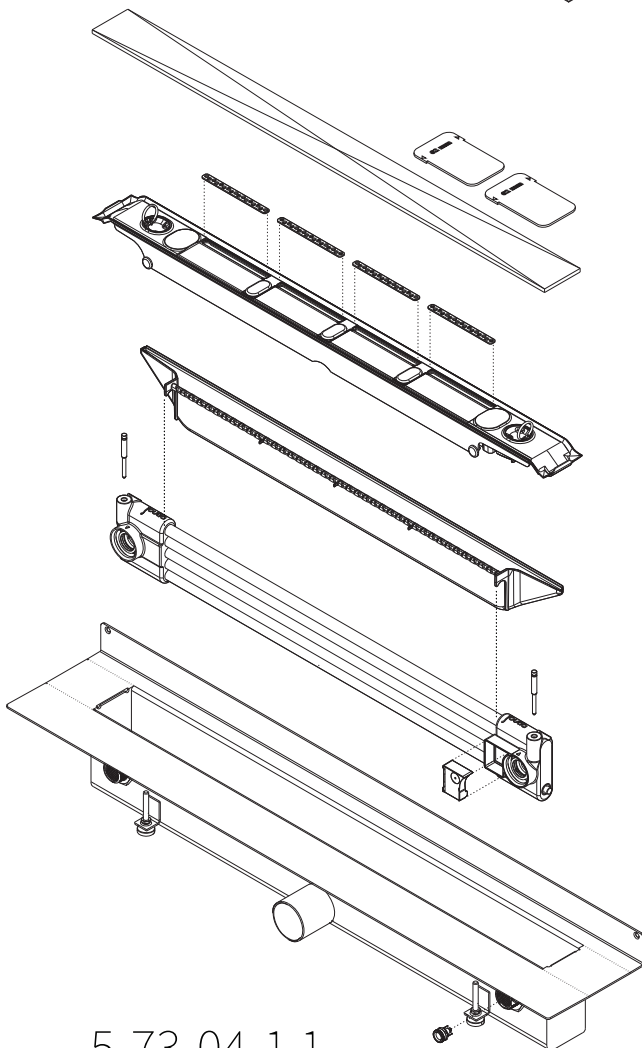
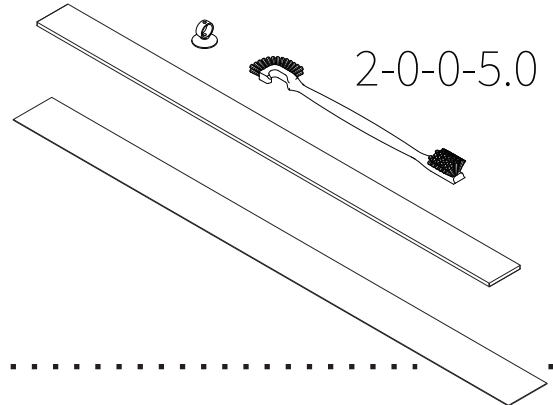

5-73-04-1.1

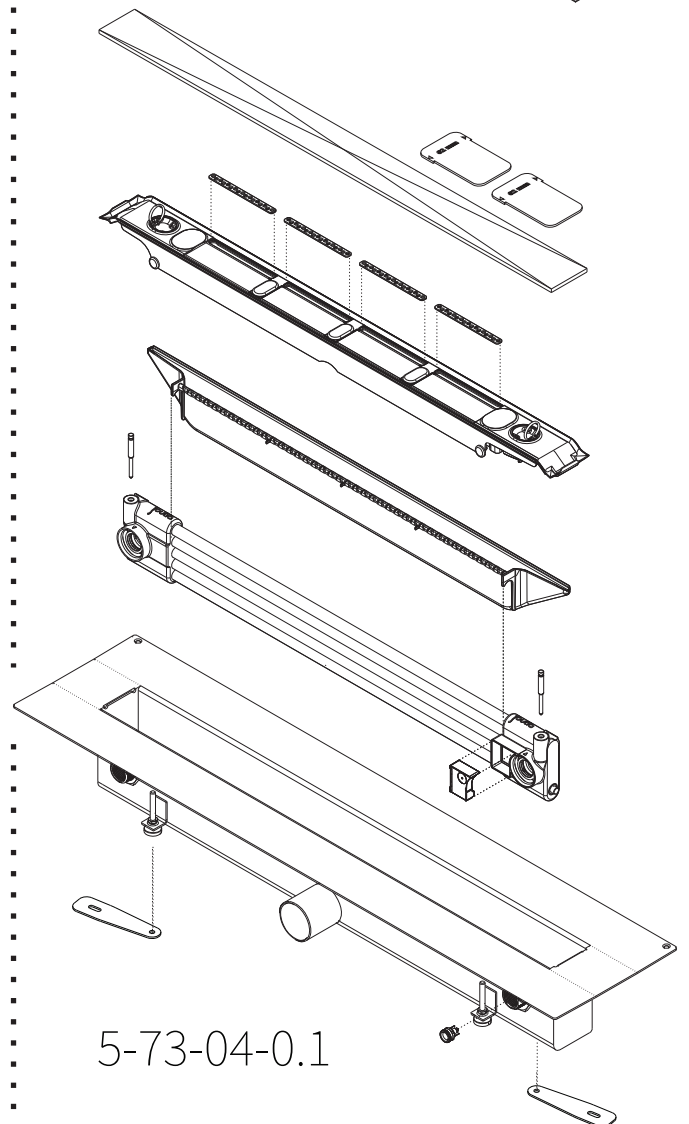

5-73-04-0.1



Für fugenlose Bodenbeläge...
Pour les revêtements de sol sans joints...
For seamless floor coverings...
Voor gietvloer...

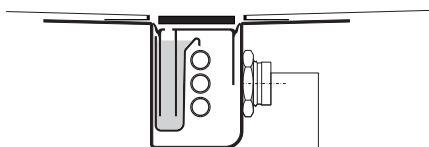

Zusätzliche Instruktionen
Instructions complémentaires
Further instructions
Verdere instructies



06



oder für Steinbeläge.
ou pour les revêtements en pierre.
or for stone coverings.
of voor steenbekledingen.

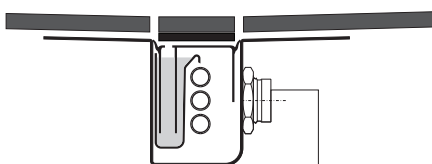

Zusätzliche Instruktionen
Instructions complémentaires
Further instructions
Verdere instructies



08

Für fugenlose Bodenbeläge
Pour les revêtements de sol sans joints
For seamless floor coverings
Voor gietvloer

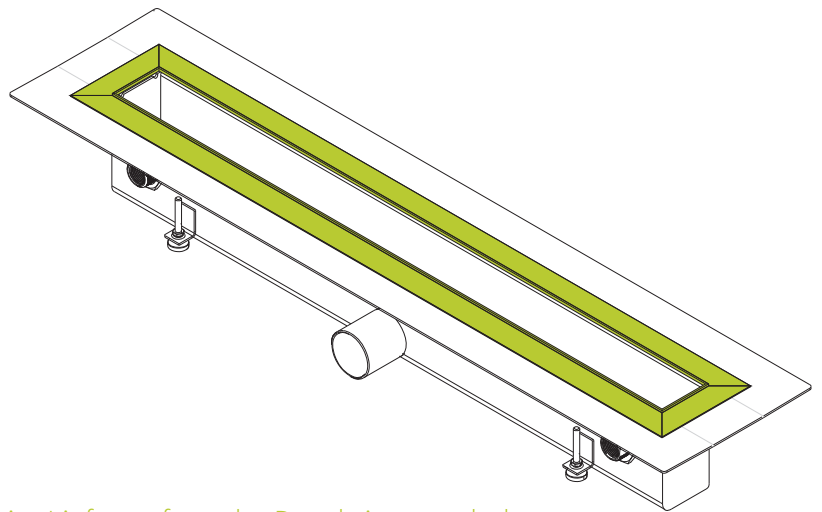

Die **Abschlussprofile** sind **nicht** im Lieferumfang der Duschrinne enthalten.
Les **profils finaux** ne sont **pas** inclus dans la livraison de la rigole de douche.
The **end profiles** are **not** included in the delivery of the shower drain.
De **afsluitprofielen** zijn **niet** inbegrepen in de levering van de douchegoot.

Abstandhalter
Espaceur
Spacer
Afstandhouder

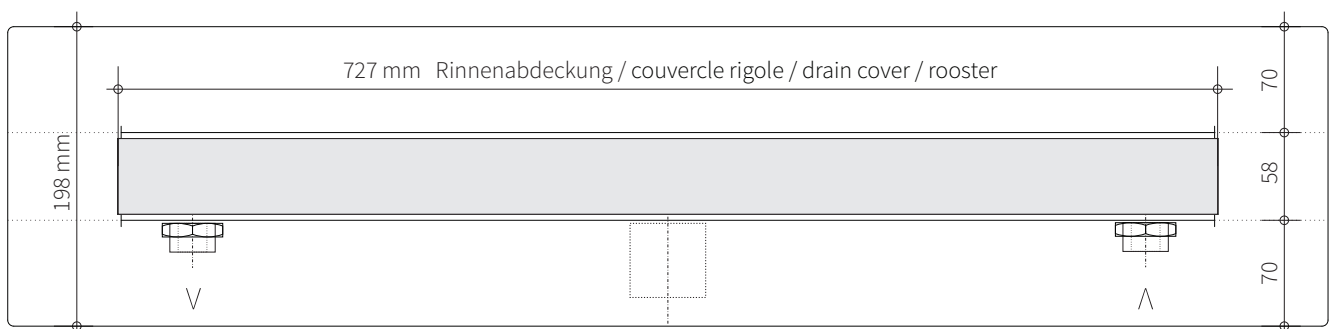
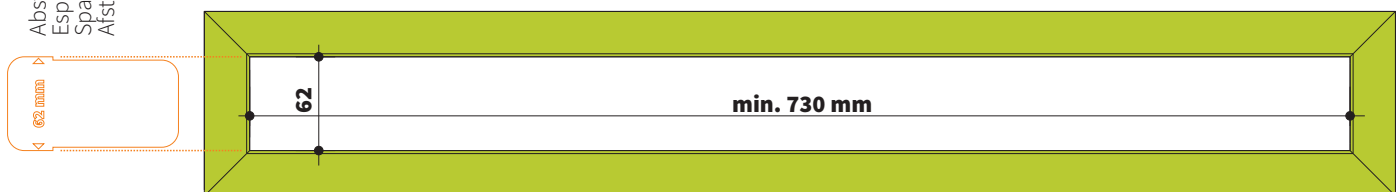

Detail 1:1

Für fugenlose Bodenbeläge
Pour les revêtements de sol sans joints
For seamless floor coverings
Voor gietvloer

Bitte Verarbeitungsrichtlinien des Belagherstellers befolgen.
Veuillez suivre les directives de traitement du fabricant de revêtements.
Please follow the processing guidelines of the flooring manufacturer.
Volg de verwerkingsrichtlijnen van de fabrikant van de vloerbedekking.

min. 730 mm
727 mm

62 mm

Abstandhalter
Espaceur
Spacer
Afstandhouder

62 mm

50 mm

6

6

70 mm

Extrabreiter Flansch
Flasque d'étanchéité extra large
Extra wide sealing flange
Extra brede flens

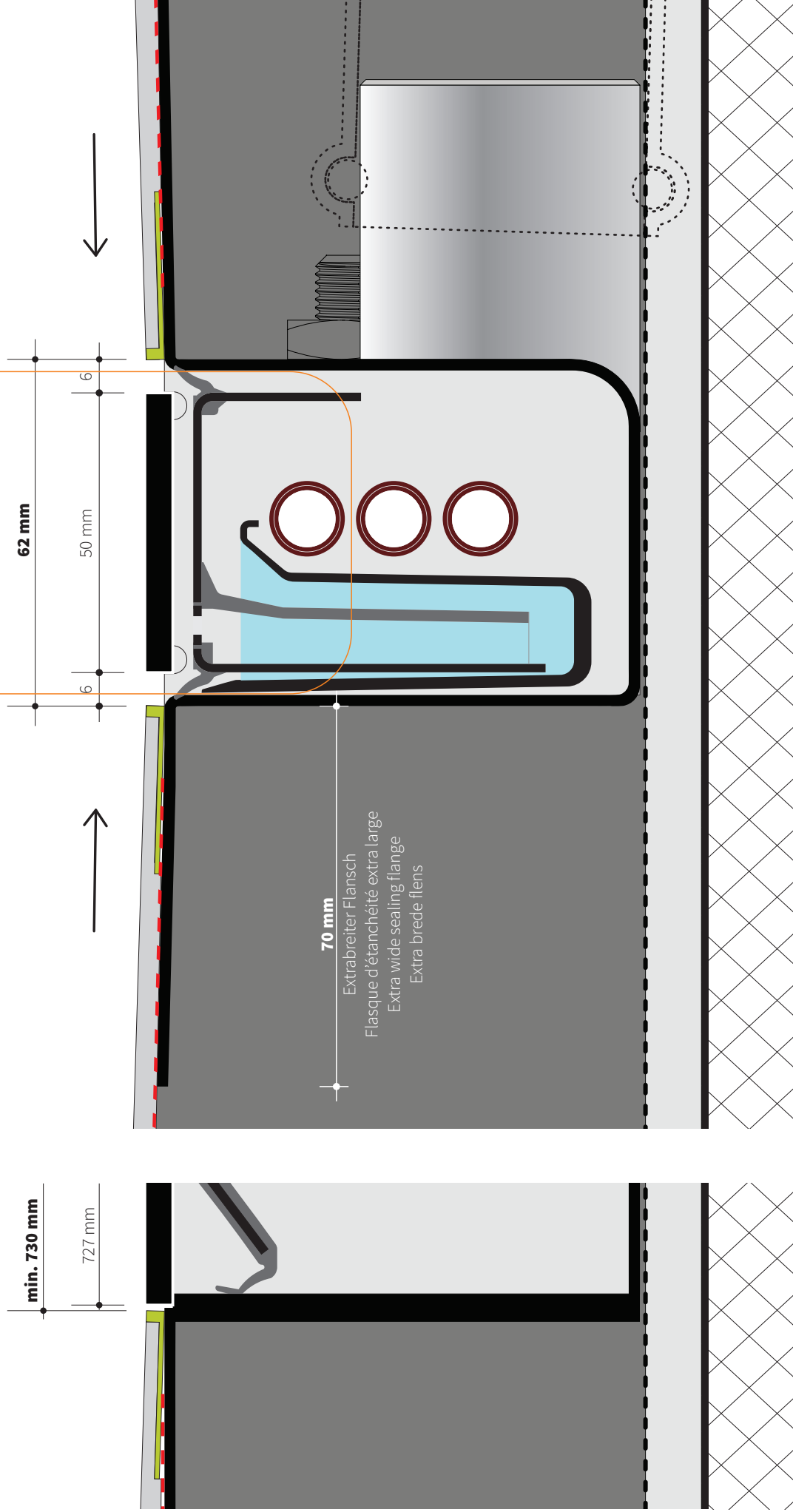

Detail 1:1

**Für Steinbeläge.
Pour les revêtements en pierre.
For stone coverings.
Voor steenbekledingen.**

joulia®
S W I T Z E R L A N D

Abstandhalter
Espaceur
Spacer
Afstandhouder

62 mm

62 mm

min. 50 - max. 54 mm

Stein auf Edelstahl geklebt
Pierre collée sur acier inoxydable
Stone glued onto stainless steel
Steen gelijmd op roestvrij staal

70 mm

Extrabreiter Flansch
Flasque d'étanchéité extra large
Extra wide sealing flange
Extra brede flens

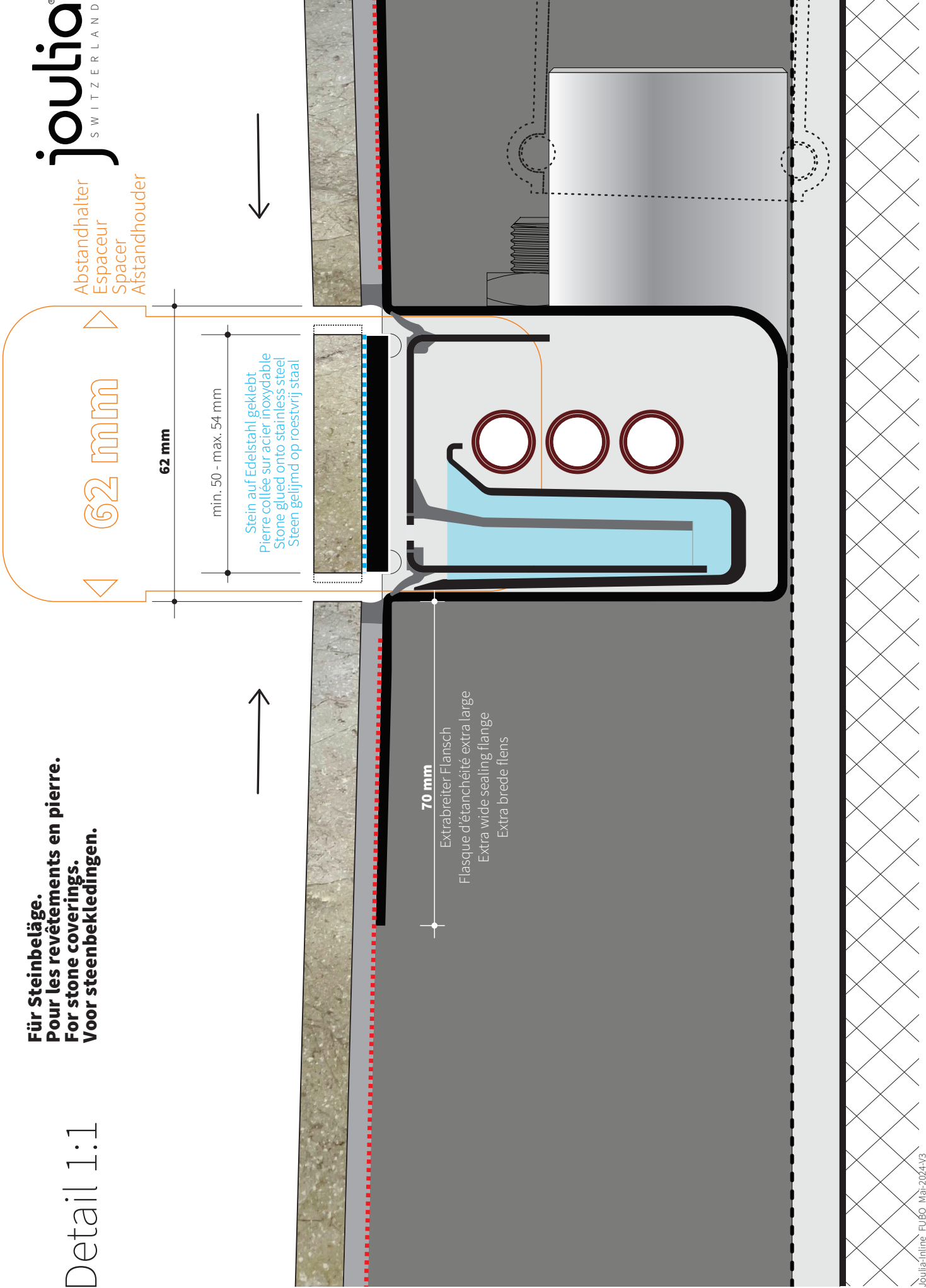

Minimal

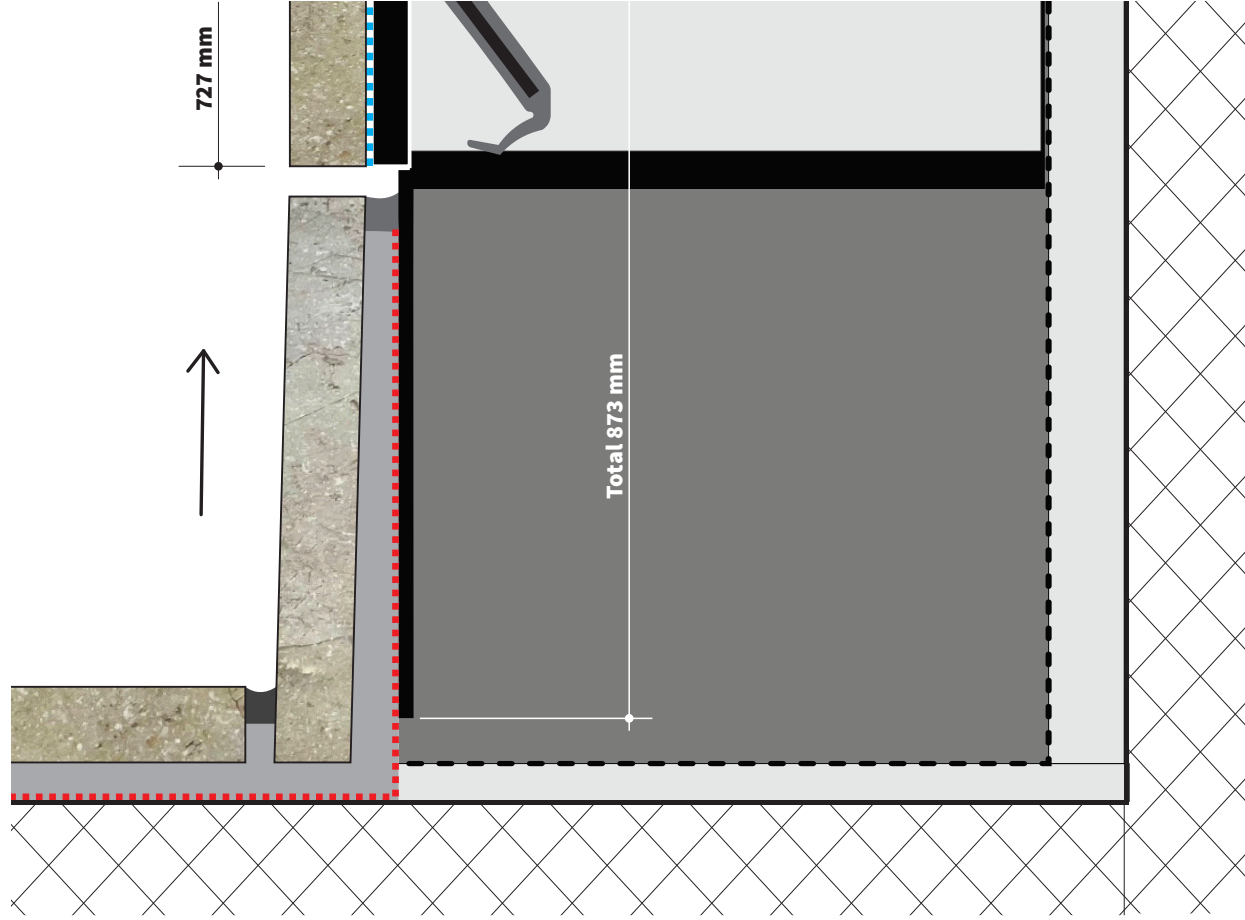

Maximal

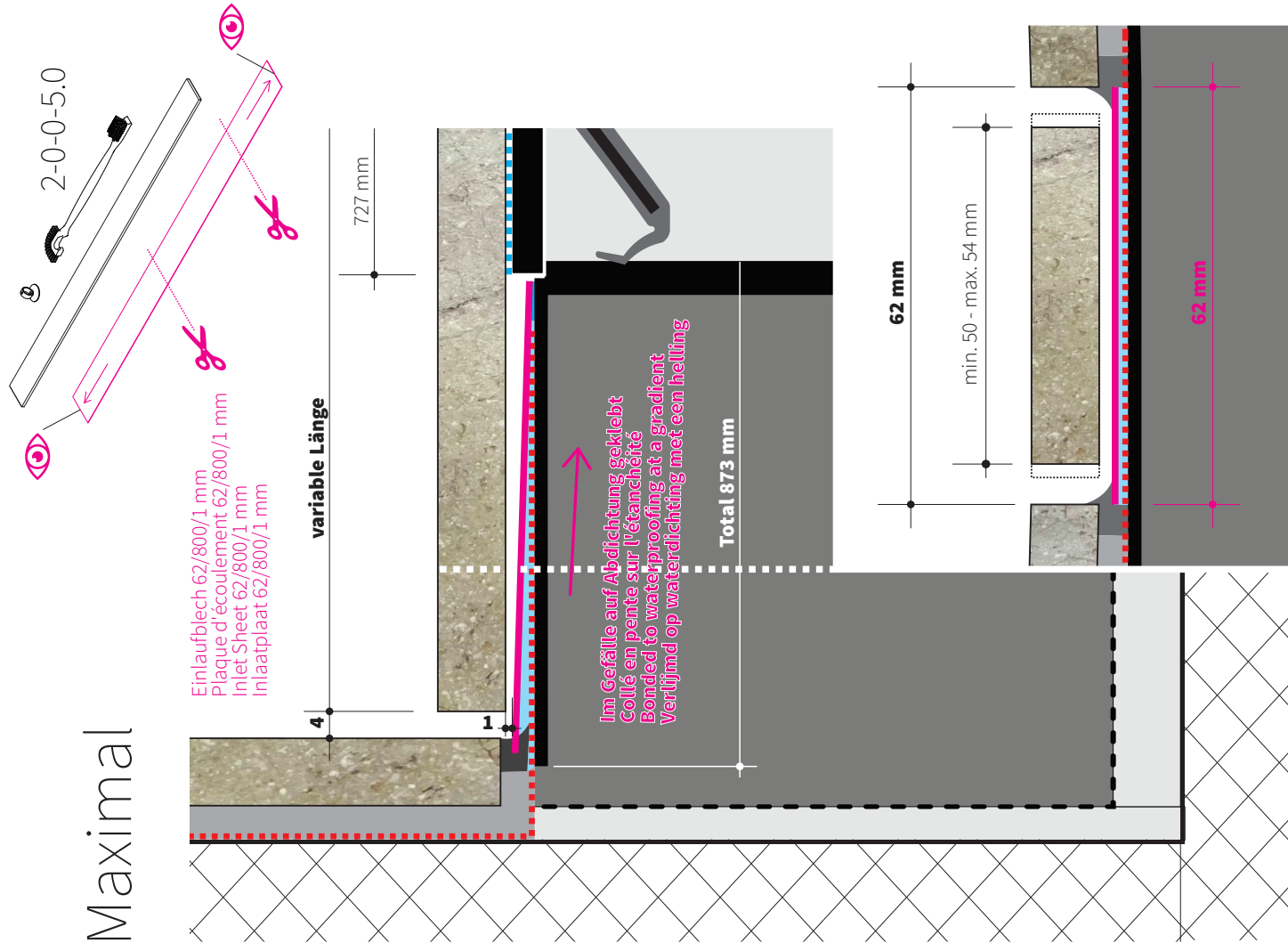

Detail 1:5

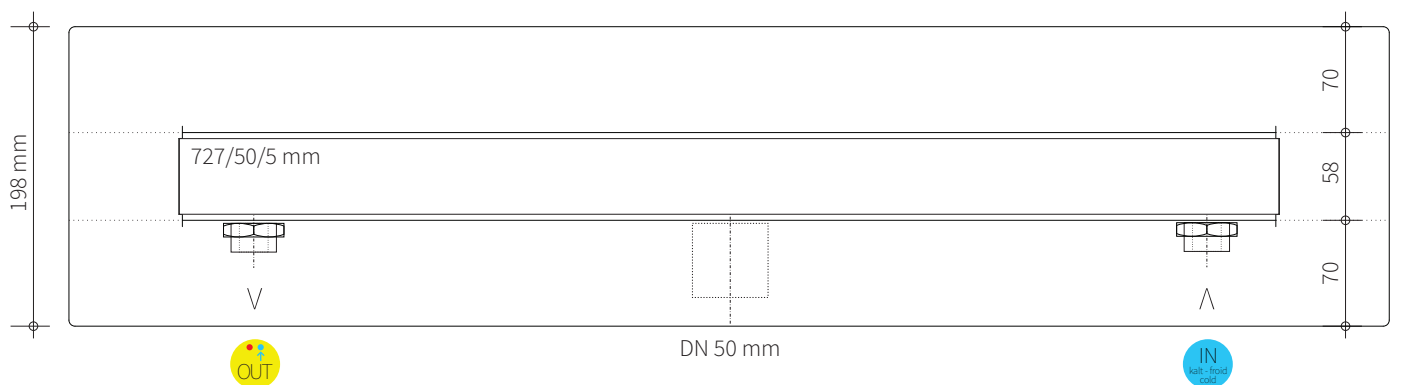
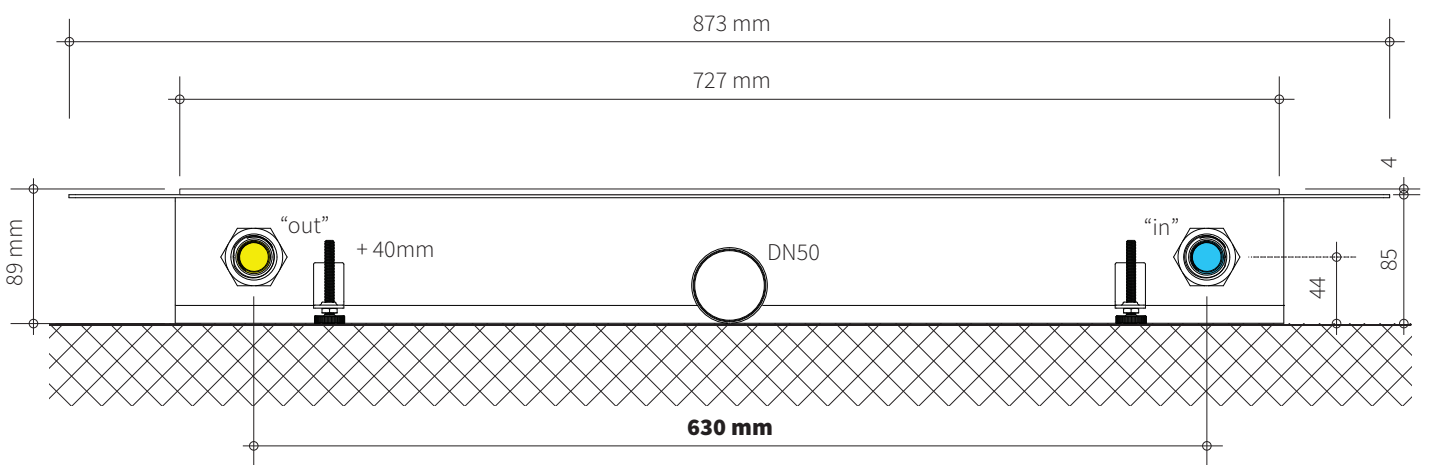
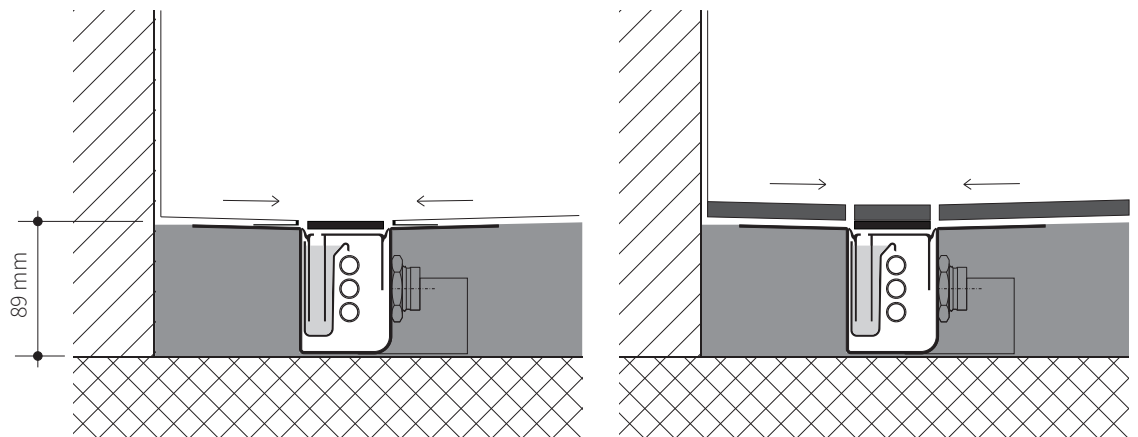

Auf Mischbatterie anschliessen **kalt**
 Se connecter au mitigeur de douche **froid**
 Connect to shower mixer **cold**
 Aansluiten op douchemengkraan **koud**

Detail 1:5

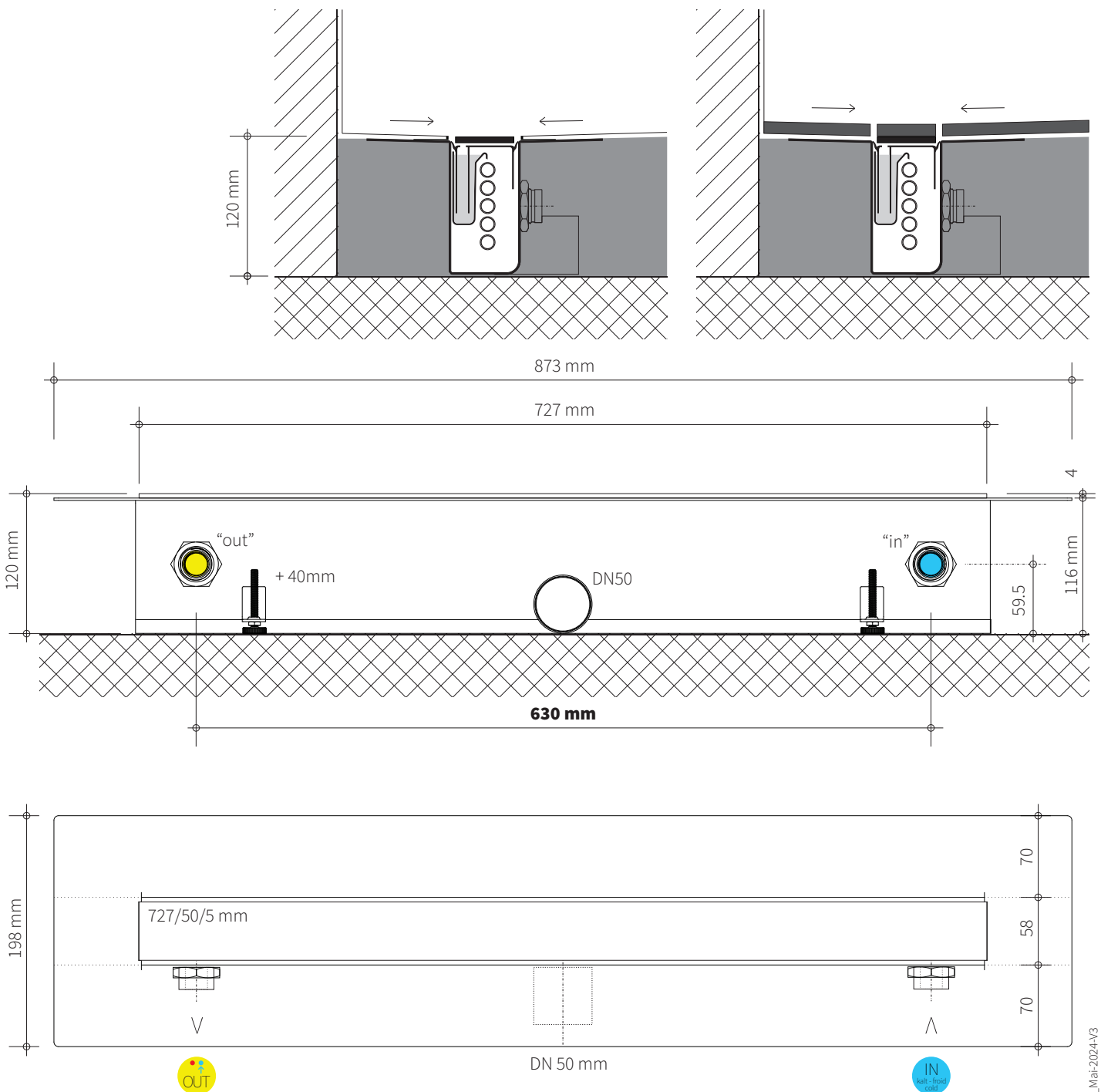

Auf Mischbatterie anschliessen **kalt**
 Se connecter au mitigeur de douche **froid**
 Connect to shower mixer **cold**
 Aansluiten op douchemengkraan **koud**



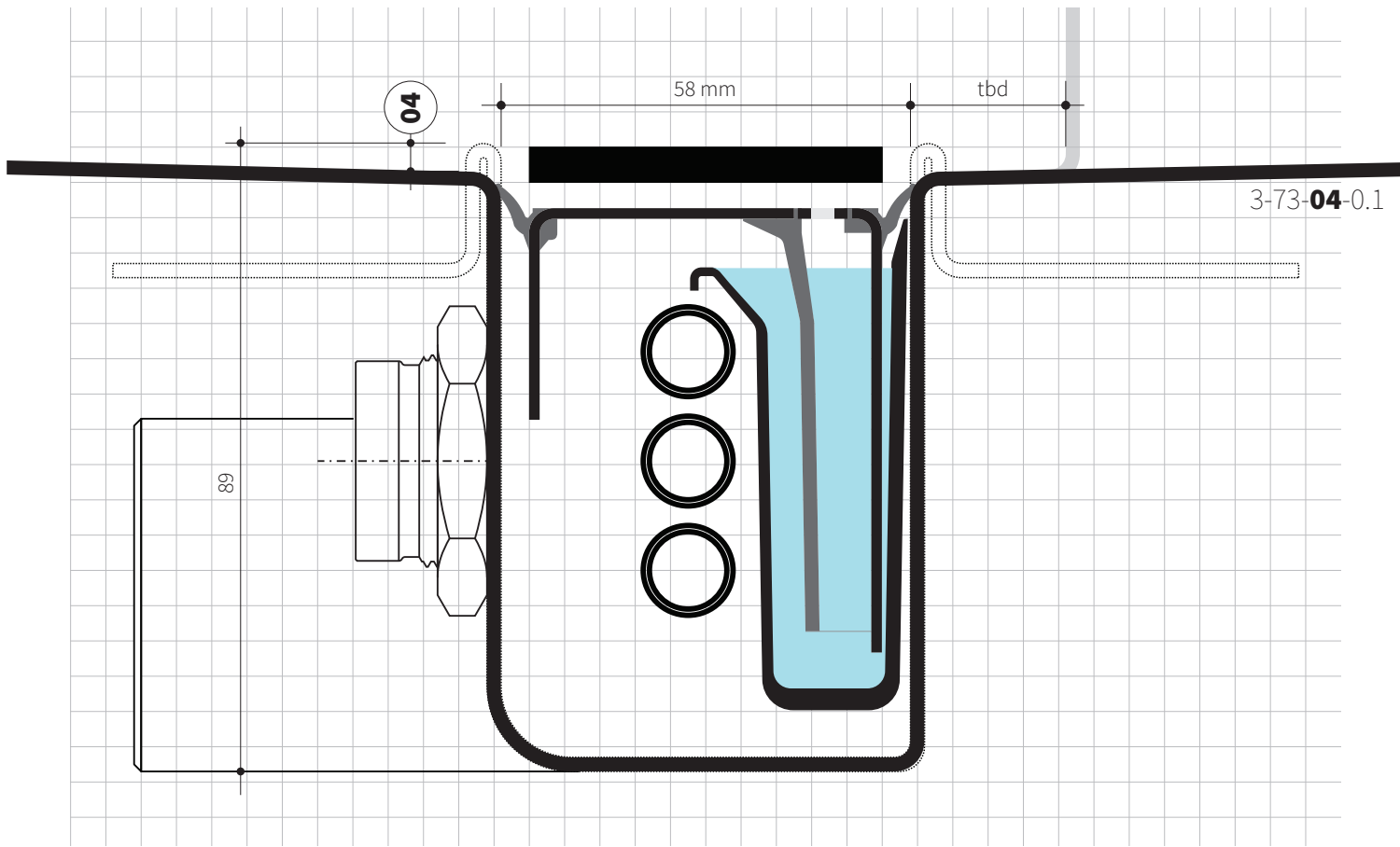

5mm/5mm

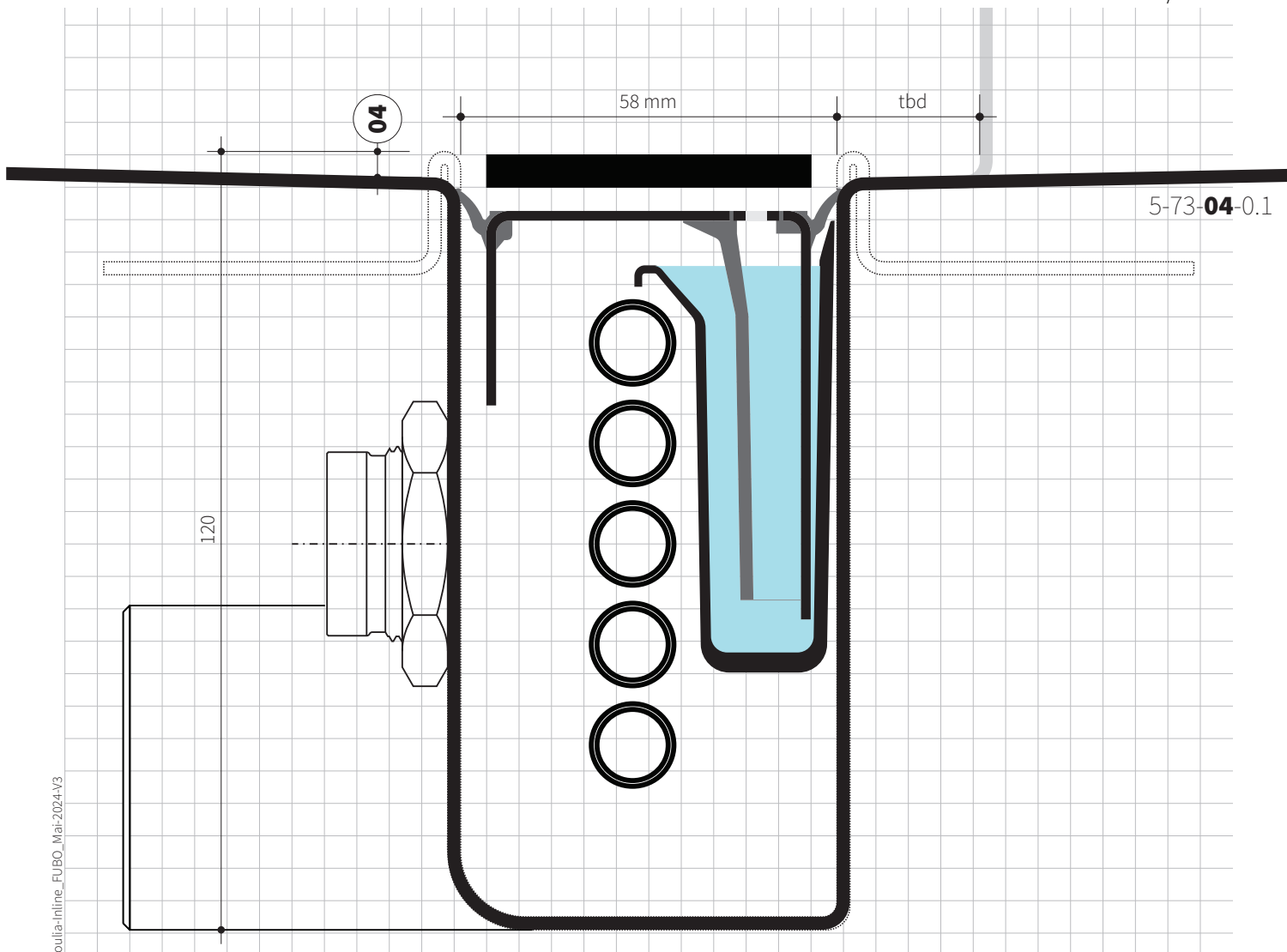

Joulia-Inline_FUBO_Mai-2024V3